

A close-up, black and white photograph of a Nitsch DSHA-3FN audio component. The device is dark-colored with a prominent silver knob in the center. The knob has a textured, knurled side and a smooth, circular top. The background is dark and out of focus, showing some horizontal lines on the top surface of the device. The overall aesthetic is minimalist and high-quality.

NITSCH

N.02

DSHA-3FN

D Differential	S Stereo	H Headphone	A Amplifier
3 Version 3	F Designed with Focals in mind	N NITSCH version	

Introduction

Congratulations on your purchase of a DSHA-3FN, a collaboration between NITSCH and Doug Savitsky of ecp Audio.

The DSHA-3F is regarded by the community as one of the best solid state headphone amplifiers, but they are now very difficult to find. We wanted to continue the life of this amp so that more people could enjoy owning one.

Thank you, Doug Savitsky for this wonderful design. And thank YOU for purchasing one!

Cheers,



Christian Tanimoto III (a.k.a. CEE TEE)



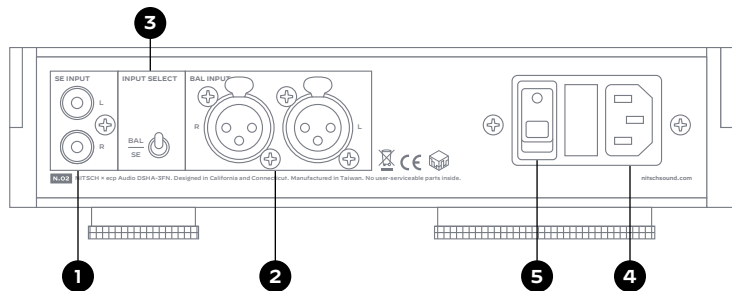

1. Connect your single-ended source to the **SE INPUT** jacks with high-quality RCA cables.

2. Connect your balanced source to the **BAL INPUT** jacks with high-quality XLR cables.

3. Set the input switch for the input you want to listen to. Select up for balanced or down for single-ended.

4. Connect the supplied power cord. Ensure the amplifier voltage matches your outlet.

5. Turn on the power switch. Up is on. Down is off.

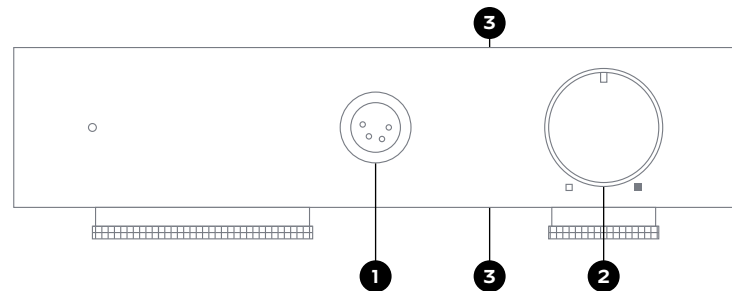

1. Connect your balanced headphones to the XLR headphone jack.

Note: DO NOT use balanced to single-ended adapters on the headphone output.

2. Turn the knob to control volume.

3. Ensure the vents on top and bottom of the amp are unobstructed.

4. Enjoy your music.

Balanced output only

DO NOT use balanced to single-ended adapters on the headphone output. Amplifier needs to run balanced out to headphones or you will damage the amplifier. Headphone cable XLR termination must be compliant with professional audio wiring standards for balanced and stereo.

Safety

- DO NOT place on top of hot surfaces or equipment. Never operate the amplifier with the case lid off or not firmly screwed into place.
- DO NOT disassemble the amplifier or open the case. There are no user serviceable parts inside.
- Always ensure that the amplifier is plugged into a grounded outlet with a properly grounded power cord.
- DO NOT allow foreign objects or any liquid to fall into the

cooling slots. If a foreign object or liquid falls into the amplifier, immediately switch off the power and disconnect from the wall outlet. DO NOT touch the unit until it is completely disconnected.

Power

- Amplifiers are either 115VAC or 220VAC, but NOT BOTH. Your amplifier is set by NITSCH and requires the proper fuse for your power setting. 110/120VAC use 160mA 250VAC 5x20mm Slow Blow fuses. 220/240VAC use 80mA 250VAC 5x20mm Slow Blow fuses.
- Connecting to an improper outlet at the wrong voltage may severely damage or destroy the amplifier.

Warranty

2 years from the date of purchase. For repair or replacement needed due to manufacturing defects.

Specifications

Frequency response ± 1 dB	5 Hz to 35 KHz	
THD 1 KHz	32 ohms	< 0.02%
	300 ohms	< 0.015%
IMD CCIF	32 ohms	< 0.0004%
	300 ohms	< 0.0003%
Dynamic range	> 120 dB	
Residual noise 20 Hz to 20 KHz	< -100 dBu / < 7.75 uV	
Crosstalk 1 KHz	< -80 dB	
Gain	1.5x, ~4 dB	
Gain linearity 0 to -110 dBu	< ± 0.2 dB	
Estimated bandwidth	< 1 Hz to > 160 KHz	
Output impedance	4.9 ohms	
Topology	Unique fully differential, deep Class A	
Size	230 mm W \times 242 mm D (case + switch + volume knob) \times 60 mm H (with feet)	
Weight	5 lbs. 2 oz. (without cable)	

NITSCH makes personal audio products for
people who value great sound. Visit us at
nitschsound.com

NITSCH

